

Want More

from your automotive
aftermarket supplier ?

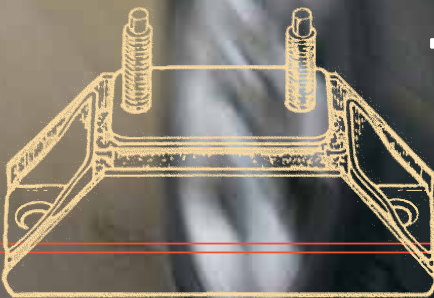

Experience.

Value.

Innovation.



How Much More ?

How about OEM-
quality, performance,
fit, form and function,
full-line coverage,
huge inventory and
great service?

Anchor Industries
IS THE ANSWER.

Manufacturing,
domestic and foreign

1

quality
standard

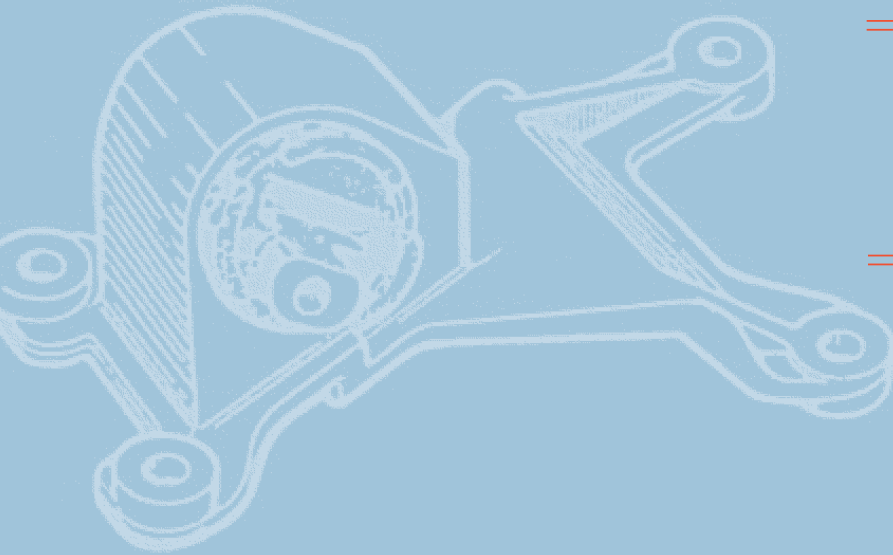

More.

We offer a broad product line of engine and transmission mounts, torque strut mounts, center support bearings, suspension strut mounts, and a wide range of flywheels, ring gears and cables.



The automotive parts industry is crowded with me-too suppliers, pretenders and wanna-be's – but there's only one Anchor Industries.

Anchor is a family owned and operated business that has represented quality and leadership in the automotive aftermarket since 1933. Only Anchor invests so much in R&D and enjoys broad market acceptance – that's the Anchor Industries difference! Let us help you secure your success.

100%

North American sales
representation coverage

THE ANCHOR DIFFERENCE:

By the Numbers

More than
75 years
of service to
the automotive
aftermarket



In excess of
\$10 million
of tooling in our
North American
manufacturing
facility

More than
5,000
part numbers
with 50 to 75
new part numbers
added each year



Over
65,000
square feet
of manufacturing
space in
North America

Immediate
availability of
15,000 tons
of steel inventory at our
steel service center



In excess of
\$25 million
of inventory in our
North American
warehouse facilities

Over
135,000
square feet
of distribution space
in the U.S.

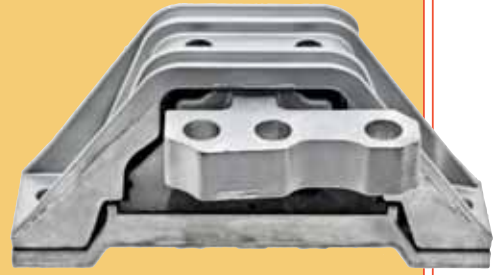

2,500

steel stamping dies
and 1,000 rubber molds
used in our U.S.
manufacturing operations



Work with the Leader

Anchor Industries has earned the reputation as the automotive aftermarket's leading supplier of engine and transmission mounts with:

R&D-driven product excellence: We are first to market with new part numbers and applications. Our research allows us to follow the new models as closely as the OEMs do, and use CAD/CAM technology to meet or exceed manufacturer specifications. Every year, we introduce 50 to 75 new, late-model part numbers to inventory. We stock hundreds of thousands of products!

Top-quality integrated manufacturing: Anchor is America's only basic aftermarket manufacturer of engine and transmission mounts. And the only full-line manufacturer worldwide. Integrated manufacturing keeps costs under control and quality at its peak. We do it by owning and operating our own raw material suppliers and component manufacturing processes – yes, we control the quality of everything we sell.

Marketplace acceptance: Full-line coverage and strong inventory commitment put Anchor at the top for service and availability. Our order fill is at or near 100 percent and our Anchor, Doan and American brands are respected the world over.

Only the market leader can do all that.



Support You Can Count On

We know how much
you value service.

And we deliver.

Every time.



You Demand	We Offer
Product quality	Products are engineered and tested to meet or exceed manufacturer specs
Fast delivery	More than \$25 million in inventory; we ship fast
Coverage	Full-line product coverage – American, European, Asian
Order fill	Consistently at or near 100 percent
Value	Competitive pricing and more – value-added services that lower your total cost
Brand names	Nobody beats Anchor, Doan and American
Warranty	OEM quality; satisfaction guaranteed
Technical support	The best engineering and quality control experts in the industry, and toll-free hotline
Catalogs	Continuous updates in print and electronic form
Marketing support	Whatever you need – POS support, private labeling, etc.